



**Kingston University** London

# Lebanese cancer patients' perception of ambulatory chemotherapy

Kingston University London

Racha Sabbagh Dit Hawasli, Pharm.D, PhD Researcher

Stephen Barton, PhD, CSci, CChem, MRSC

Shereen Nabhani-Gebara, Pharm.D, BCOP



- I declare to meeting attendees that there are no financial relationships with any for-profit companies that are directly or indirectly related to the subject of my presentation
- The authors would like to thank all of Dr. Hady Ghanem and the Lebanese American University Medical Center-Rizk Hospital, and Dr. Ghazi Nsouli and Rafic Hariri University Hospital for facilitating the study.



## Background

- Ambulatory chemotherapy (AC) → standard of care for certain cancers in most developed countries
- Slow but successful uptake of AC in Lebanon



# Conventional versus ambulatory chemotherapy

## Ambulatory chemotherapy

## Conventional chemotherapy

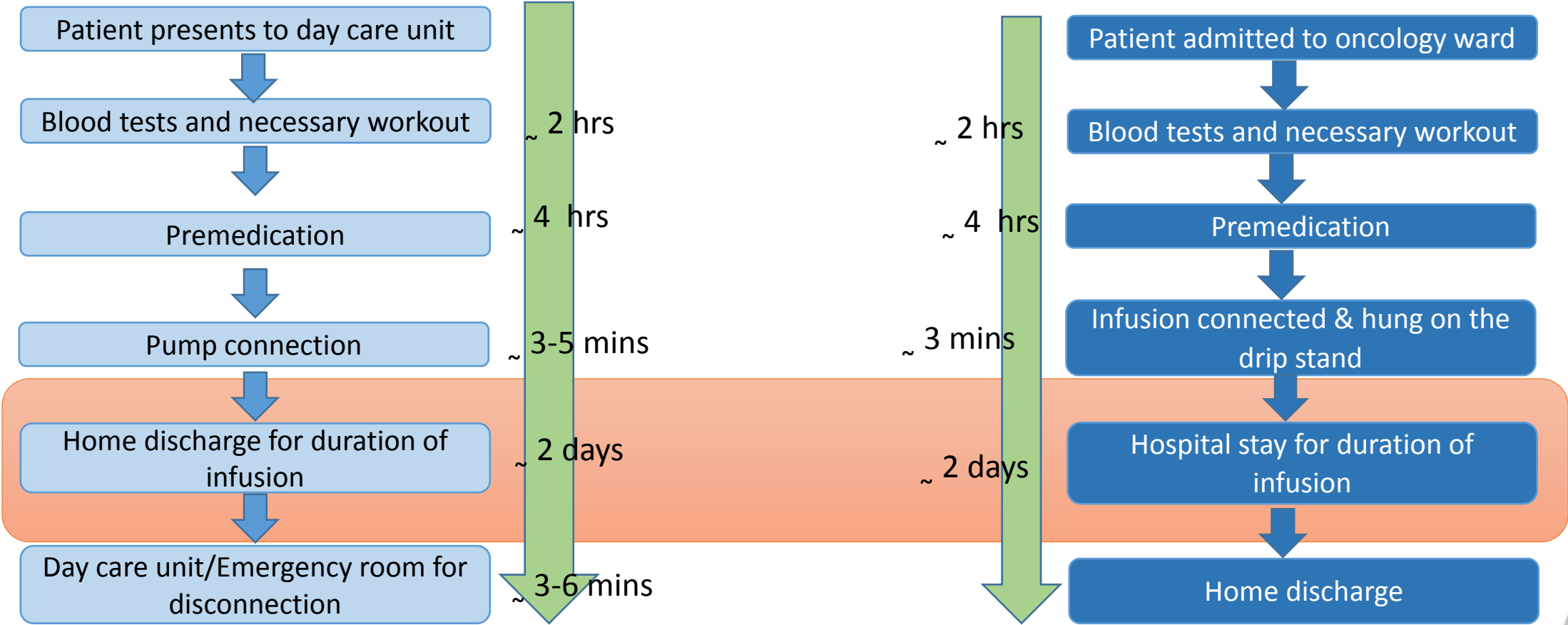



# Conventional versus ambulatory chemotherapy

*Conventional in-hospital chemotherapy delivery*



- Hospital fees
- Nosocomial infections

*Ambulatory chemotherapy*



- Normalcy
- Social role

*Elastomeric infusion pump*

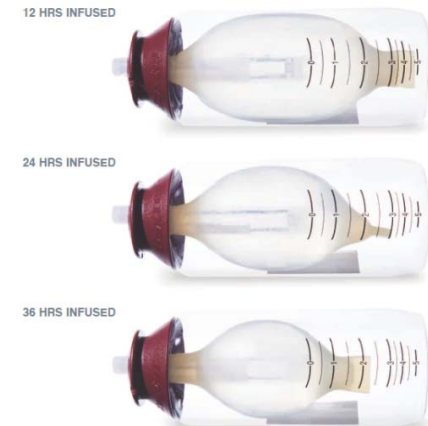

# Porta-cath





## Aim of the research

- Aim: analyze the factors influencing patient acceptance of AC
- Published in abstract form
- 25<sup>th</sup> OPL congress: Correlating the findings to the roles of the pharmacist



## Materials and Methods

- Cross-sectional qualitative study
- 2 medical centers in Lebanon over 5 weeks
- Ethics committees at Kingston University London and at each of the two hospitals where the study was conducted
- 29 patients recruited in total
- The audio recorded interviews were transcribed and translated into English, then coded and analyzed with NVivo software using inductive thematic analysis, and using Roger's diffusion of innovations theory





## Correlation of findings to Everett Roger's theory of Diffusion of innovations

Diffusion is defined as “the process by which (1) an **innovation** (2) is **communicated** through certain channels (3) over **time** (4) among the **members of a social system**“

### 1) Characteristics of an innovation

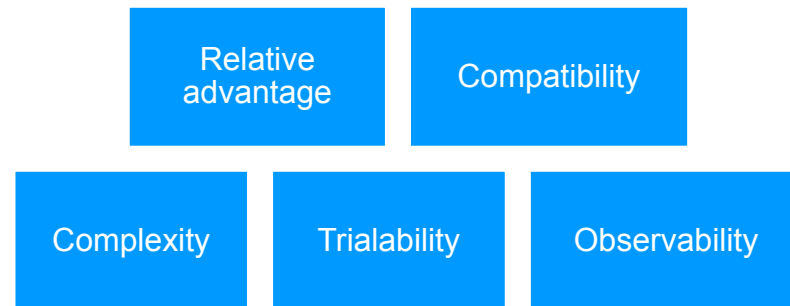

### 2) Communication channels

- Mass Media
- Interpersonal channels

### 3) Time

#### Innovation-decision process

- Knowledge
- Persuasion
- Decision
- Implementation
- Confirmation

#### Innovativeness of the individual

- Innovators
- Early adopters
- Early majority
- Late majority
- Laggards

#### Innovation's rate

- Influenced by the 2 previous characteristics
- Uptake is slow at first (innovators), followed by a sharp increase then it levels off

**4) Social system and its norms** influences the individual innovativeness and behaviour

# Patients' characteristics

(n=29)

Median Age	Gender		Employment		Education			
	Male	Female	Unemployed	Employed	University graduate	School graduate	Non higher education graduates	Unknown
53	14 (48%)	15 (52%)	19	10	14	4	9	2

# 1- Patients' worries and hesitation

- Lack of **observability** and **awareness** on AC

"هيدي شغله مايعرف شي عنها"

"ولا مرة سمعنا عنا شي، ولا مرة شفناها"

- Unclear **relative advantage** of AC

"كيف بآثر علي هالشي؟"

- Pump perceived as **complex** to handle

"بتصور انها لبكة، لبكة المضخة"

# 1- Patients' worries and hesitation

- Lack of **awareness** on CVC

"ولا مرة تعاملنا مع هيك شي من قبل، وهو خارج نطاق إستيعابي، فأنا مافبي أعطيكى جواب"



## 2- Misconceptions

### ■ Misconceptions on CVC

"ما فيني وطي أو إنزل إلأط شي من الأرض لما يكون الدوا موصول عل الوبرتاكاث"

"سمعت انو الوبرتاكاث إجمالاً بسبب مشاكل ونزيف والتهابات"



## 3- Patients' Needs

### ■ Overwhelmed patients

" يعني كنت بعدني مبلش علاج وفوقا كنت بعدني عارف انو معي سرطان وانو رح اخذ كيماوي وهيك فقالت لحالي كمان في بعد جاييني قصة الشامبر وهيك ما بدني هالشي كلو "

### ■ Patient's need for AC

" أفضل ما الواحد يضيع وقتو ويقعد بالمستشفى "

" يعني بس اجي عالمستشفى بصير كأني أعد على نار، بنظر لحظة يلي بفل في من هون "



## 3- Patients' Needs

- Patient's **need for CVC**

"أنا عملت عمليتين ومن بعدن صار كثير صعب إنو يلقولي شريان ، هيدا بس يلي زعجني، كانو عمبوجعوني لما يجربو يشكو المصل، بس رجعت قلت لحالي يمكن أهين من الشمبر"

- **Lack of involvement in decision making**

"بالنسبة إلي بفضل دائماً إستشير طبيبي يعني إذا قول إنو أفضل اخدو وروح عالبيت باخدو وبروح عالبيت وإذا بقول إنو ضل بالمستشفى تحت المراقبة بضل"



## 3- Patients' Needs

- **Trying** the ambulatory pump within hospital premises

"يعني يمكن لأول مرة، الواحد ما بيعرف شو ناظرو فالأفضل ياخذها بالمستشفى . بس يصير اخذ عليها بصير مرتاح أكثر وفيو ياخذها عالبيت"

- This correlates with the fact that patients expressed "*psychological relief*" towards hospital stay

"كل شي موجود هون بحال صار شي وكمان في راحة نفسية، أنا شخصياً بفضل المستشفى عن إنو كون بالبيت"





## 3- Patients' Needs

- Lack of **social reinforcement** from family members

" بديك تاخذ علاجك هون! مين راح يظبتلك الدوا إذا رحت عالبيت؟! "

- **Financial burden**

" كيف بدي إقدر إدفع كلفة العلاج؟ من وين بدي جيب المصاري؟ "



# The seven-star Pharmacist

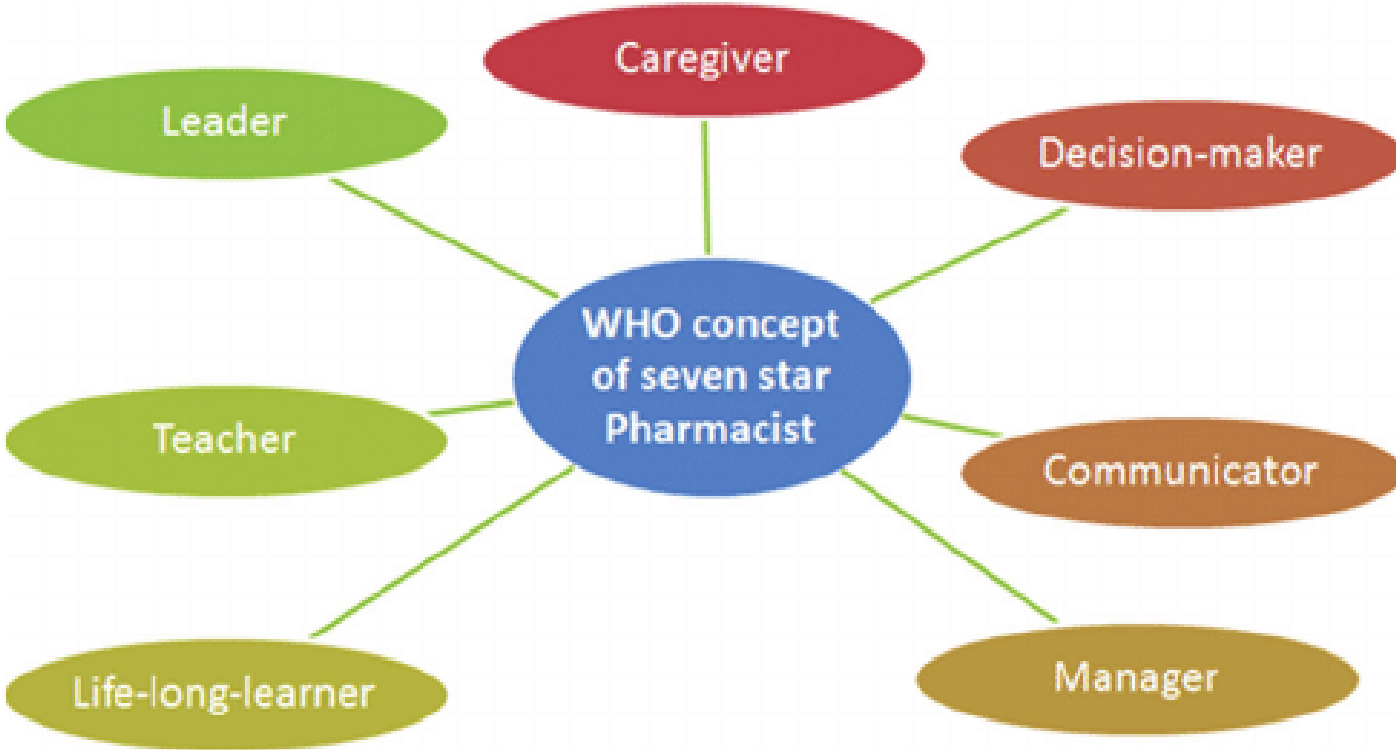



# 1- Pharmacist as caregiver

*Pharmacist as caregiver in clinical practice offering patient education and counselling on AC*

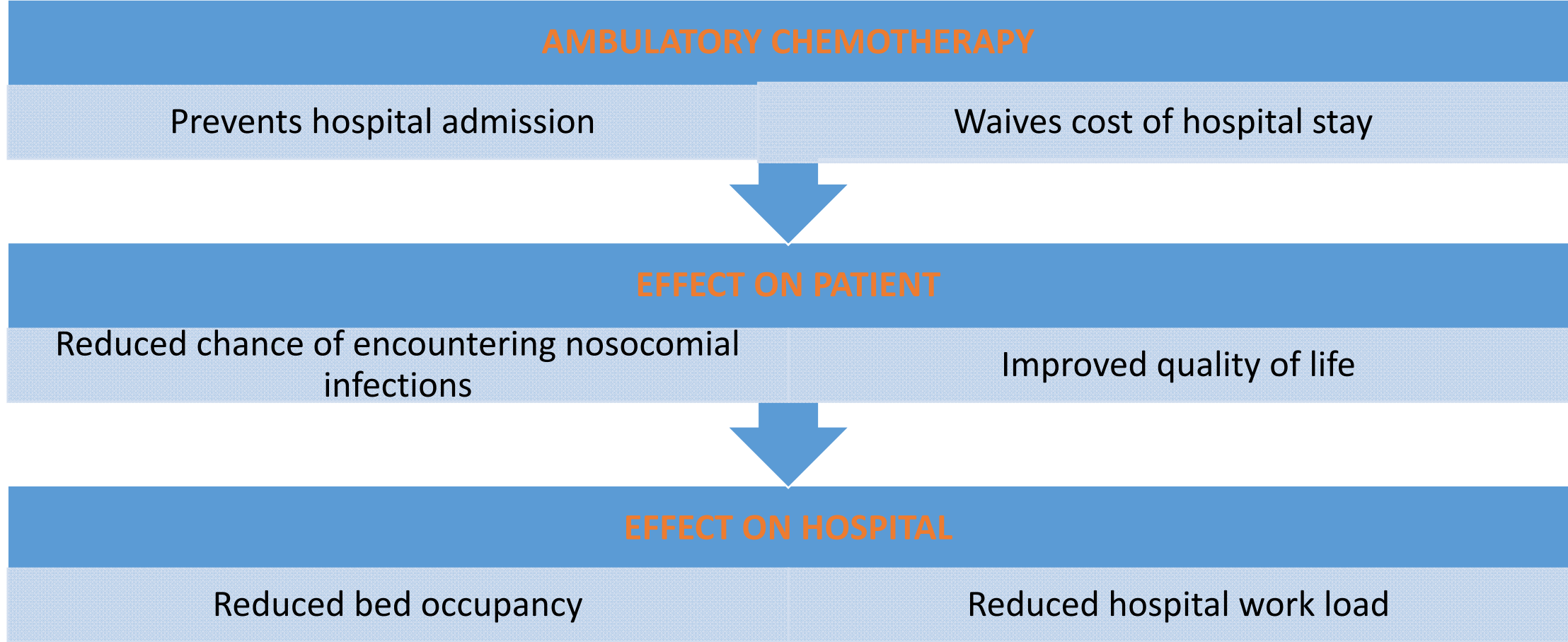

# 1- Pharmacist as caregiver

*Pharmacist as caregiver in clinical practice offering patient education and counselling on AC*

- Pump components
- Application (antibiotic, pain management medication, iron chelation, chemotherapy)
- Advantages (lightweight, portable, discreet, safe, effective)
- Monitor emptying
- Back to hospital for disconnection

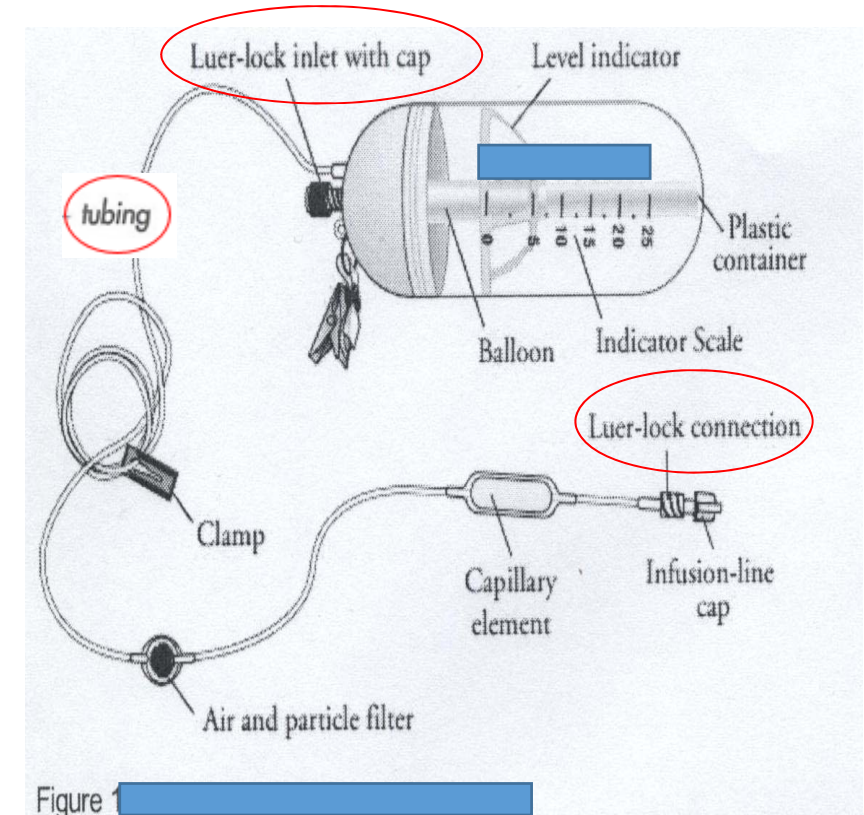



# 1- Pharmacist as caregiver

*Pharmacist as caregiver in clinical practice offering patient education and counselling on AC*



- ✓ Do not submerge pump in water
- ✓ Do not expose to water stream
- ✓ Wrap in plastic bag



- ✓ Keep at same height of catheter connection
- ✓ Keep under pillow
- ✓ Do not place above the head



- ✓ Exercise after consulting your physician
- ✓ Keep pump at room temperature



# 1- Pharmacist as caregiver

*Pharmacist as caregiver in clinical practice offering patient education and counselling on CVC*

This is a thin flexible tube inserted into a central vein, usually near the heart, with the other end of the tube providing access for drug administration or blood withdrawals. This provides a patent access for the nurse to infuse the treatment yet saves you the pain of frequent needle pricks



# 1- Pharmacist as caregiver

*Pharmacist as caregiver in clinical practice clearing misconceptions on CVC*

Leaning forward whilst the portacath is accessed (or while it is not) is okay and has no implications on your safety

"ما فيني وطي أو إنزل إ لأط شي من الأرض  
لما يكون الدوا موصول عل الوبرتاكاث"





# 1- Pharmacist as caregiver

*Pharmacist as caregiver in clinical practice clearing misconceptions on CVC*

Any venous access device (peripheral or central) is associated with potential risks including disconnection, obstruction, infection, etc. Avoiding direct water onto the accessed portacath, and reporting any unusual symptoms to your doctor are crucial for using the portacath safely. In fact, the portacath will reduce the chances of other complications such as extravasation and bruising from repetitive needle pricks, that are usually encountered with peripheral access devices.



" سمعت انو الوبرتاكاث إجمالاً بسبب مشاكل ونزيف والتهابات "





# 1- Pharmacist as caregiver

*Pharmacist as caregiver in clinical practice offering timely counselling and avoiding information overload*

Avoid unfamiliar terminology or jargon

Assess patient's need for information

For elderly patients use large print brochures, plain language, repetitions



## 1- Pharmacist as caregiver

*Pharmacist as caregiver in clinical practice empowering patients to participate in decision making*

- Empowerment defined by the WHO

*“a process through which people gain greater control over decisions and actions affecting their health” and should be seen as both an individual and a community process”*

- Patient understanding of his/her role
- Acquiring knowledge to participate in treatment plan
- Developing skills
- Supporting environment



# 1- Pharmacist as caregiver

*Pharmacist as caregiver in clinical practice empowering patients to regain normalcy*

- Providing patient education and counselling on self care to accept out of hospital treatment
  - Normalcy to patients' lives
  - Alleviating workload
  - Treating more patients in need



## 2- Pharmacist as Communicator

*Pharmacist enhancing communication in clinical practice between patients and physicians*

- Pharmacist missing from the scene in patients' response
- Strategic position for pharmacist
- Communicating patient's needs to physicians



## 2- Pharmacist as Communicator

*Pharmacist as communicator in clinical practice* signposting patient to NGO's for support and social reinforcement



**Barbara Nassar**  
FOR CANCER PATIENT SUPPORT



[www.BARBARA.im](http://www.BARBARA.im)  
Barbara Nassar Association



#IamBarbara



**FACE** Cancer  
Foundation for Advocacy Care and Education for Cancer



## Conclusion

### 1- Role of the pharmacist as a **care giver**

- patient education and counselling

→ on AC and CVC

→ on self care in general to accept out of hospital treatment

- Patient empowerment

→ tailoring treatment to patient preferences

### 2- Role of the pharmacist as a **Communicator**

→ Patient's voice to physician

→ Signposting patient to NGO's for support and social reinforcement

### 3- Role of the pharmacist as a **Researcher**

# Conclusion

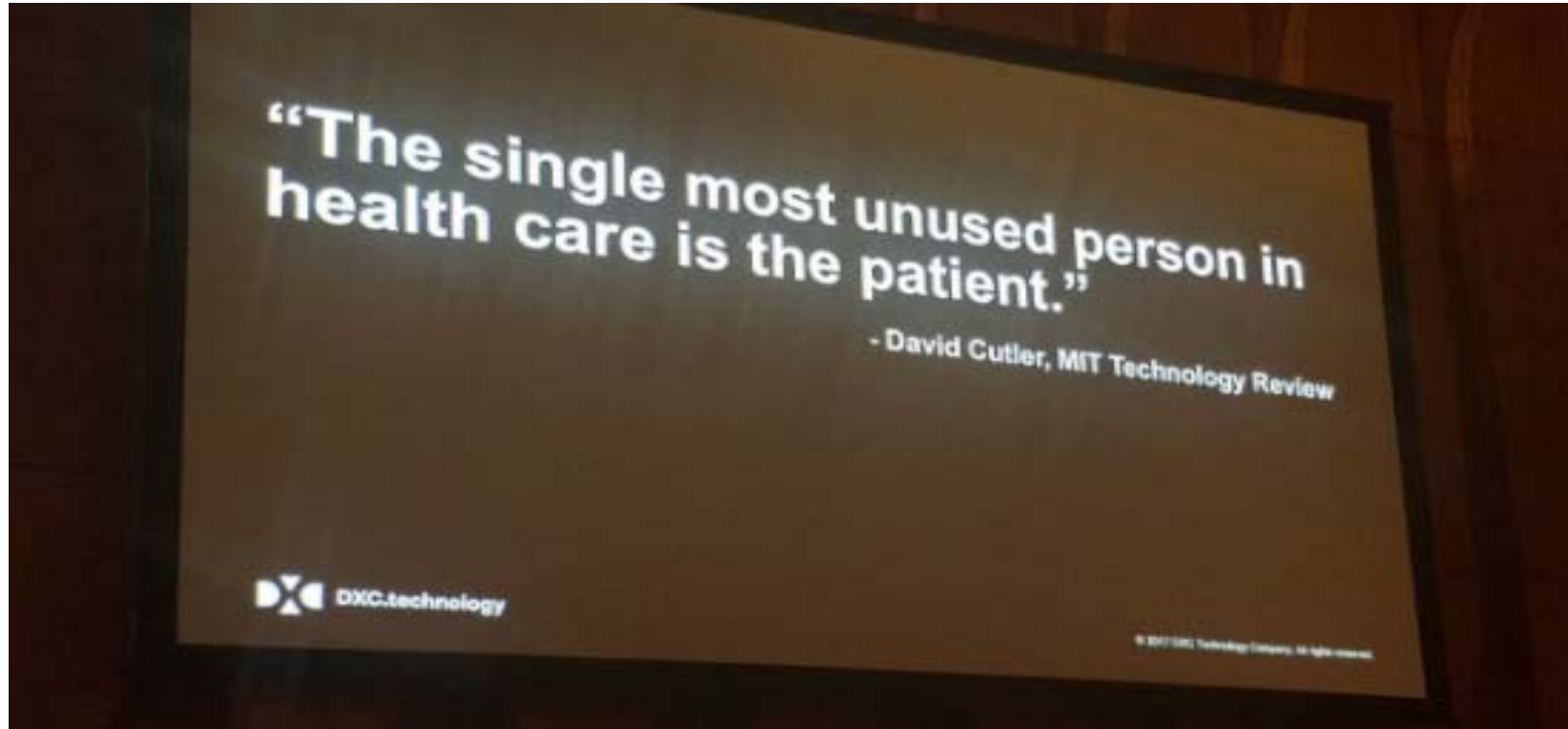

## References

- 1- Healthcare or Medical, Masterfile, digital photograph. Accessed on 2 July 2014, [http://image1.masterfile.com/em\\_w/01/15/27/632-01152749w.jpg](http://image1.masterfile.com/em_w/01/15/27/632-01152749w.jpg)
- 2- Patient with connected ambulatory pump. Accessed on 30 November 2014, [http://2.bp.blogspot.com/-vX5exGBHB3E/TVsh\\_Pp4drl/AAAAAAAAABjg/V8nKx4Bdmtc/s320/pump1.jpg](http://2.bp.blogspot.com/-vX5exGBHB3E/TVsh_Pp4drl/AAAAAAAAABjg/V8nKx4Bdmtc/s320/pump1.jpg)
- 3- “Baxter Elastomeric Pumps. Clinician Guide”. Baxter. Health Technology Safety Research Team. N.d. Web. Retrieved July 1<sup>st</sup> 2014 from: <http://www.capca.ca/wp-content/uploads/Baxter-Elastomeric-Pumps-Clinician-Guide11.pdf>
- 4- Diagram showing an implantable port, diagram, CancerHelp UK, Accessed on 20 March 2015, <http://4.bp.blogspot.com/-fWJPy4H5Zw8/T3PLfGllrgI/AAAAAAAAAbE/I5kuKG0pVu8/s1600/implantable%255B1%255D.gif>
- 5- Dawn, 2011, Portacath: what is it and will it hurt?, digital photograph, Accessed on 20 March 2015, <http://thefaceswelive.com/2011/10/11/portacath-what-is-it-and-will-it-hurt/>
- 6- Dr. Eisen Liang, 2012, What are the aftercares required?, digital photograph, Sydney Interventional Radiology, Porta Cath insertion Patient information, Accessed on 30 November 2014, [http://www.sir.net.au/portacath\\_pi.html](http://www.sir.net.au/portacath_pi.html)
- 7- Porta cath accessed for blood work and treatment. Accessed on 30 November 2014, <http://i.ytimg.com/vi/ZhaiCPzbmMI/maxresdefault.jpg>
- 8- Leannology, 2015, digital photograph, Accessed on 20 March 2015, <http://www.leannology.com/2012/11/11/the-wheeeeeze/>
- 9- Rogers, E. M. (2003). Diffusion of innovations. New York: Free Press.
- 10- The 7 star pharmacist. Monash University. Accessed on 18 November 2017 from <https://www.monash.edu/rlo/assignment-samples/pharmacy-and-pharmaceutical-sciences/pharmacy-reflective-writing>
- 11- Dosisfuser pump components and legend. Accessed on 10 November 2017 , <http://www.omnimedicalsupply.com/dosi-fuser.htm>
- 12- Committee on Improving the Quality of Cancer Care: Addressing the Challenges of an Aging Population; Board on Health Care Services; Institute of Medicine; Levit L, Balogh E, Nass S, et al., editors. **Delivering High-Quality Cancer Care: Charting a New Course for a System in Crisis**. Washington (DC): [National Academies Press \(US\)](http://www.nationalacademies.org); 2013 Dec 27.
- 13- Geneva: [World Health Organization](http://www.who.int); 2009. WHO Guidelines on Hand Hygiene in Health Care: First Global Patient Safety Challenge Clean Care Is Safer Care. ISBN-13: 978-92-4-159790-6. Accessed on 10 November 2017 from <https://www.ncbi.nlm.nih.gov/books/NBK144013/>





Thank you

